

Vertical Body | Knob/ADA Handle on Top



PRODUCT FEATURES

- Wireless connectivity through BLE (Bluetooth Low Energy)
- IP55 rated, FCC, CE and IC certified
- Brushed nickel or black finish
- All metal housing
- Visual and audible indicators
- Advanced auto unlock
- ADA compliant
- Multiple options for knob style, cam type, and cylinder length
- Vertical orientation – knob on the top or bottom
- Horizontal orientation – knob on left or right

FUNCTIONALITY

- Dual functionality - shared or assigned use
- Manage with the DigiLink cloud based network application
- Operate by User pin or Mobile ID

INSTALLATION

- Designed for both new or retrofit installations
- Adaptable to multiple door thicknesses with varying cylinder lengths
- 90° or 180° knob rotation, clockwise or counter-clockwise to unlock

POWER

- Up to 5 years battery life with average use
- Powered by 4 premium AA batteries

SUPPORT

- On-site product updates
- Lifetime Support
- 2-year warranty



Vertical Body | Knob/ADA Handle on Top

TOP VIEW

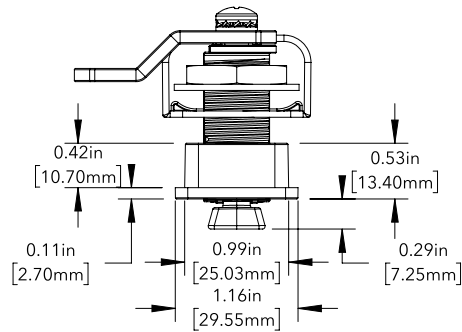

SIDE VIEW

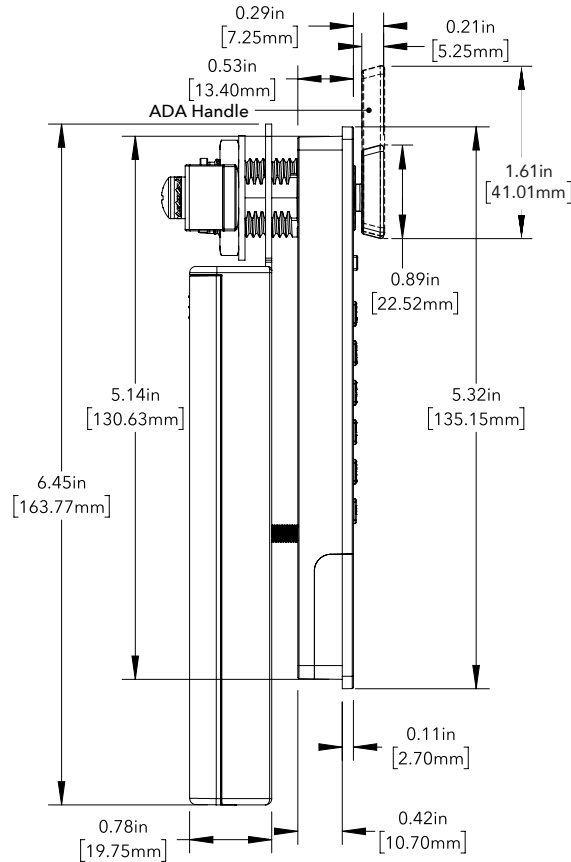

FRONT VIEW

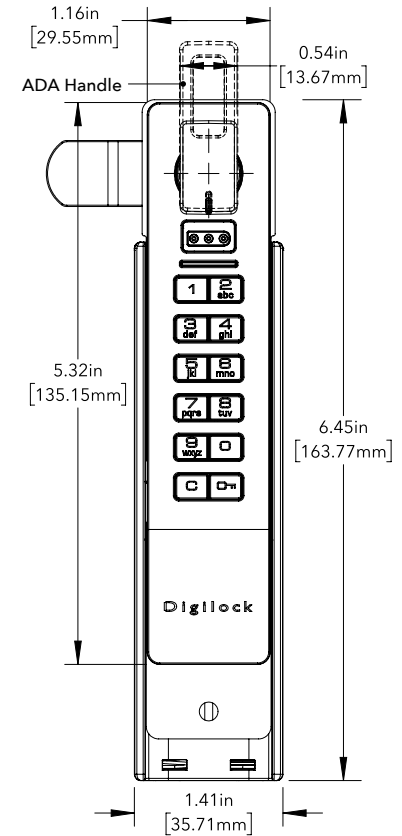

CYLINDER LENGTH

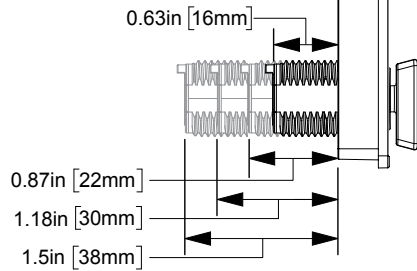

CAM OPTIONS

Offset Cam

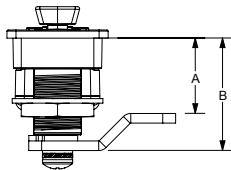

Flat Cam

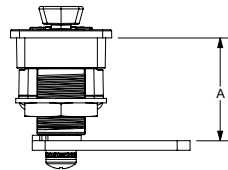

Lifter Cam

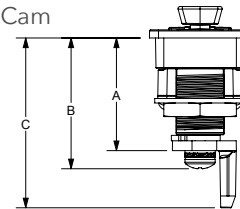

Slam Latch

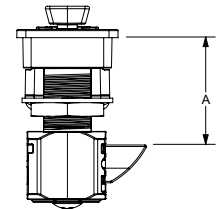

	16MM CYLINDER	22MM CYLINDER	30MM CYLINDER	38MM CYLINDER
A	0.74in (18.92mm)	0.98in (24.92mm)	1.30in (32.92mm)	1.61in (40.92mm)
B	1.23in (31.18mm)	1.46in (37.18mm)	1.78in (45.18mm)	2.09in (53.18mm)

	16MM CYLINDER	22MM CYLINDER	30MM CYLINDER	38MM CYLINDER
A	1.10in (28mm)	1.34in (34mm)	1.65in (42mm)	1.97in (50mm)

	16MM CYLINDER	22MM CYLINDER	30MM CYLINDER	38MM CYLINDER
A	1.23in (31.25mm)	1.47in (37.25mm)	1.78in (45.25mm)	2.10in (53.25mm)
B	1.47in (37.25mm)	1.70in (43.25mm)	2.02in (51.25mm)	2.33in (59.25mm)
C	1.97in (50.16mm)	2.20in (56.16mm)	2.53in (64.16mm)	2.84in (72.16mm)

	16MM CYLINDER	22MM CYLINDER	30MM CYLINDER	38MM CYLINDER
A	1.16in (29.5mm)	1.4in (35.5mm)	1.71in (43.5mm)	2.03in (51.5mm)